

FEATURES/CARATTERISTICHE

Materials available/Materiali disponibili:	PP+GF; PVDF+CF
Max flow/Portata massima:	90 m ³ /h
Max head/Prevalenza massima:	38 m
Max temperature/Temperatura massima:	PP 60°C; PVDF 90°C
Max viscosity/Viscosità massima:	200 cSt
Pressure rating/Pressione nominale massima:	NP/PN 6 @ 20°C
Pump weight/Peso pompa:	PP: 42 Kg; PVDF: 44 Kg
Motor weight/Peso motore (approx.):	7.5 kW: 39 Kg; 11.0 kW: 122 Kg; 15.0 kW: 133 Kg; 18.5 kW: 163 Kg

SECTION AND PARTS LIST/SEZIONE E LISTA PARTI

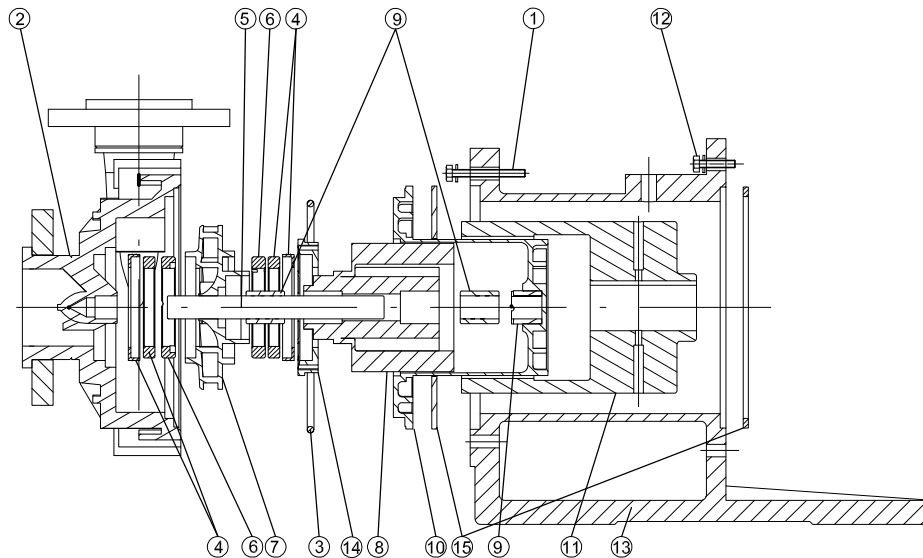

POS.	1	2	3	4	5	6	7	8	9	10	11	12	13	14	15
PART DESCR.	SET SCREWS	PUMP HEAD	O-RING	CASING THRUST BUSH	SHAFT	IMPELLER THRUST BEARING	IMPELLER	INT. MAGNET	BEARING	REAR CASING	EXT. MAGNET	SET SCREWS	BRACKET	REAR SUPPORT	RING
MATERIALS	AISI304	PP+GF PVDF+CF	EPDM VITON	Al ₂ O ₃ EPDM VITON	Al ₂ O ₃	PTFEC	PP PVDF	PP PVDF NeFeb	PTFEC	PP+GF PVDF+CF	CS NeFeb	AISI304	Cast Iron Aluminium	PP PVDF	AISI 304 AISI 316

CURVES/CURVE 50HZ-2900 RPM

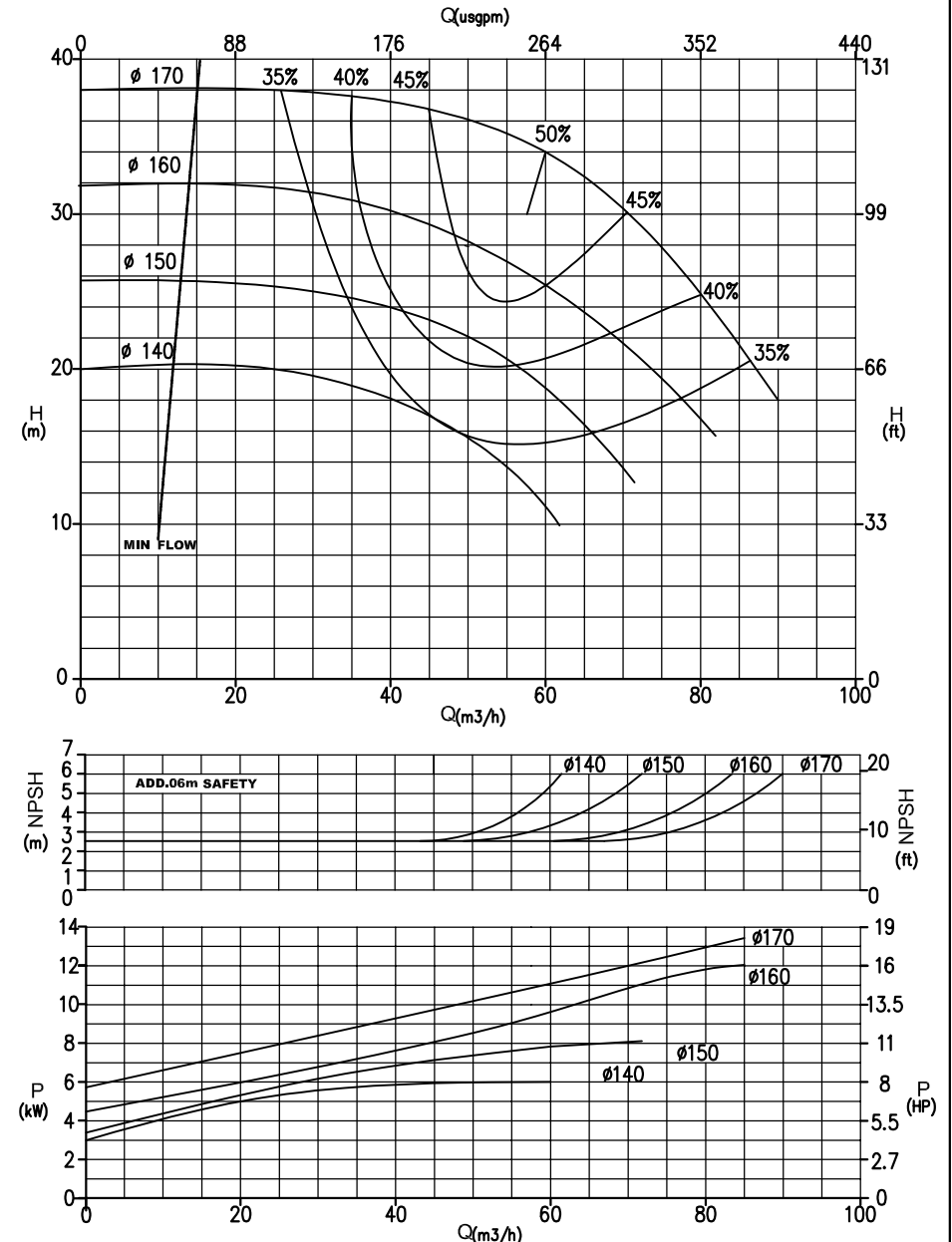

All data stated are an indication and are liable to change without notice / Tutti i dati sono indicativi e possono variare senza preavviso